

# REB16大中空系列

REB16 Large-Bore Brake

## 产品特点 Product Features

- ⊙ 内孔大、体积小、制动扭矩大
- ⊙ 间隙调整方便
- ⊙ 运行无滑转分离时没有残留扭矩
- ⊙ Large inner bore, Compact size, high braking torque
- ⊙ Easy gap adjustment
- ⊙ Slip-free operation and no residual torque when disengaged
- ⊙ 采用螺钉安装, 使用维护简单
- ⊙ 温升高、节能
- ⊙ 低噪音
- ⊙ Easy installation with screws, simple to use and maintain
- ⊙ Low-temperature rise, energy-saving
- ⊙ Low noise
- ⊙ 零背隙
- ⊙ 无摩擦片, 产品符合RoHS要求
- ⊙ 高温下也能保持稳定的扭矩
- ⊙ No backlash
- ⊙ No friction plate, compliant with RoHS standards
- ⊙ Stable torque even at high temperatures

## 技术参数 (DC24V) Technical Data (DC24V)

机座号 Base No.	静摩擦扭矩 Static torque T s	线圈 (20℃时) Coil parameters (at 20℃)				耐热等级 Heat Resistance	最高旋转速度 Maximum rotation speed (min <sup>-1</sup> )	衔铁吸引时间 Engaging Time (ms) t <sub>a</sub> (S)	衔铁释放时间 Releasing Time(ms) T <sub>ar</sub> (S)	质量 Weight (kg)
		电压 Voltage (V)	功率 Power (W)	电流 Current (A)	电阻 Resistance (Ω)					
REB16-01	0.05	24	2.2	0.083	261.8	F	6000	0.015	0.02	0.04
REB16-02	0.2	24	4.2	0.167	137.1	F	6000	0.02	0.03	0.06
REB16-03	0.4	24	6.3	0.25	91.4	F	8000	0.02	0.03	0.07
REB16-04	1	24	10.6	0.44	54.3	F	8000	0.02	0.03	0.09
REB16-05	2	24	4.3	0.18	132	F	8000	0.08	0.03	0.12
REB16-06	3.5	24	6.5	0.27	88.6	F	10000	0.08	0.03	0.16
REB16-07	4.5	24	10	0.42	57.6	F	10000	0.12	0.03	0.3

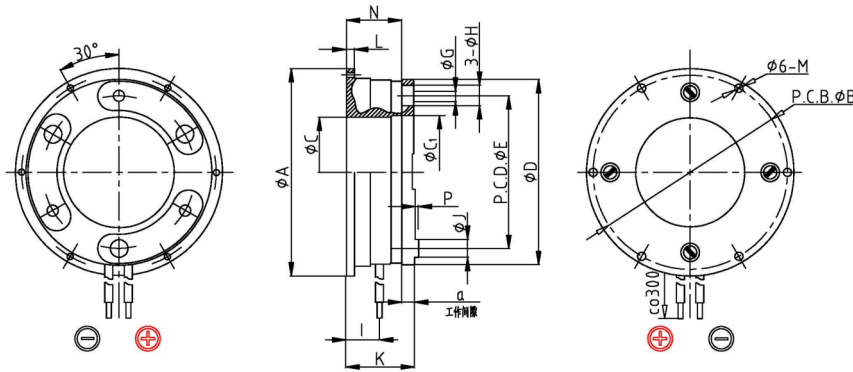

## 安装尺寸表(mm) Dimensions for Installation (mm)

机座号 Base No.	径向尺寸 Radial Dimensions (mm)										轴向尺寸 Axial Dimension (mm)							
	A	B	B	C1	D	E	G	H	J	P	L	I	K	N	X	a	M	
REB16-01	18	14	5	5	18	14	2.1	4	4	1.5	-	6	15	13.5	4	0.1-0.2	M2	
REB16-02	28	22	10	10	28	20	2.1	4	4	1.5	-	6	13.5	11	4	0.1-0.2	M2	
REB16-03	42	40	22	22	40	31	2.1	4.6	4	1.5	-	6	11.8	9.5	4	0.15-0.25	M2	
REB16-04	45	40.5	28	28	40.5	34	2.1	3.5	3	1.5	2	6	13.5	11	4	0.15-0.25	M2	
REB16-05	54.5	51	28	30.5	48	39	3.1	6.5	5.5	1.5	2	9.2	18.1	14.7	4	0.15-0.25	M3	
REB16-06	60	54	30	32	54	44	3.1	6.5	5.5	1.5	2.5	10.2	19.1	16.3	6	0.2-0.3	M3	
REB16-07	70	64	36	38	64	54	3.1	6.5	5.5	1.5	3	11.2	24.2	19.5	6	0.25-0.35	M3	