

REB31

电梯曳引机电磁安全制动器

REB31 Safety Electromagnetic Brakes for Elevator Traction

产品特点

- 安全性高: 采用独特的线圈设计,符合EN81、GB7588
- 温升低: 定子温升极低
- 扭矩大: 最大扭矩可以做到单个制动器扭矩1700N.m
- 噪音低: 独特的减噪技术,噪音最低可达50dB(A)
- 手动释放力矩低: 大扭矩下能轻松实现手动释放
- 微动开关可根据客户需求选配

Product Features

- High safety: use an unique coil to design conforming to EN81 and GB7588 standards
- Low temperature-rising: temperature of stators rises very low
- Large torque the maximum torque per brake is up to 1700N.m
- Low noise: Adopt unique noise reduction technology, the lowest noise can reach to 50dB(A)
- Low manual-releasing torque: the brake can be released manually in case of large torque
- Microswitch is optional based on customers requirement

应用范围

- 低层直梯曳引机
- 中高层直梯曳引机

Application

- Low floor straight elevator traction machine
- Middle or high floor straight elevator traction machine

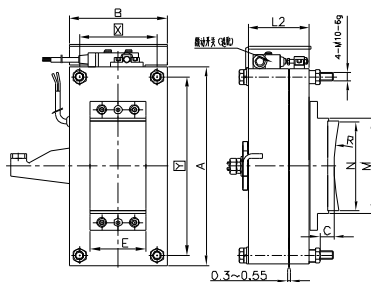

技术参数

Technical Data

系列 Series	扭矩 Torque (N.m)	A	B	X	Y	E	L2	M	N	R	C
3101	200~300	200	110	85	175	62	68	115	108	13~190	客户自定 Customer Requires
3101	600~750	245	120	95	220	68	76	118	110	180~230	客户自定 Customer Requires
3101	850~1000	250	126	95	220	68	80	118	110	200~230	客户自定 Customer Requires
3101	1000~1350	260	135	110	235	68	80	118	110	210~290	客户自定, 安装螺钉为4x12 Customer Requires