

REB30 系列弹簧加压电磁安全制动器

REB30 Spring-applied Safety Electromagnetic Brake

产品特点

- 采用螺钉安装, 使用维护简单
- 手动释放便于安装维护
- 间隙调整方便
- 无石棉摩擦片, 温升低、节能, 符合RoHS要求
- 微动开关、安装孔径大小可选

Product Features

- Use screw to install, easy application and maintenance
- Manual release for convenient installation and maintenance
- Gap adjustable
- None asbestos in friction plate, accord to ROHS Standard
- Optional installation bore diameter and microswitch

应用范围

- 自动扶梯
- 曳引机械
- 自动人行梯
- 提升设备

Application

- Escalator
- Traction Machinery
- Moving Sidewalk
- Lifting Device

技术参数

Technical Data

型号 Model	扭矩 Torque (N.m)	最大工作转速 Max. Work Speed (rpm)	安装孔径d Installation Pore Diameter (mm)	额定电压 Rated Voltage (V-DC)	额定功率 Rated Power (W)	重量 Weight (kg)
REB3016	130	4300	30	110	67.2	13
REB3018	180	3600	30/35	110	67.2	16.5

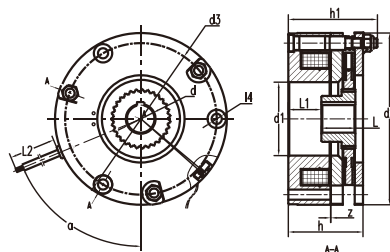

尺寸单位: mm

型号 Model	d1	d2	h	h1	d3	d4	z	L	L1	L2	a
REB3016	80	187	81.3	97	165	3-φ11	0.3	37	36	300	67.5
REB3018	80	215	86.4	107	186	3-φ13	0.3	40	35	300	65